

# SL7™ - DG6MHC VAULT

240/240/240 FRR Relocatable Vault



## SL7™ - PRODUCT/TECHNICAL BULLETIN



***“Relocatable, Zero Separation & 4hr Fire Protection”***



## DG6MHC VAULT

### Product/Technical Data Sheet



#### *Product Description:*

The DG6MHC Vault is a WorkSafe, 'Type D' approved storage vault meeting the requirements of 240/240/240 FRR and used primarily for the storage of hazardous substances in confined spaces where zero separation, relocatability and being certified compliance ready to site are major benefits.

#### *Customer Benefits:*

- SL7** 240/240/240 FRR compliant
- SL7** Zero separation to buildings and boundaries – class dependent
- SL7** Ideal solution where building to boundary separation is an issue
- SL7** Internally banded
- SL7** Arrives to site 'business ready', certified compliant for use
- SL7** Relocatable – can be dropped at site or relocated to a new site
- SL7** Saleable asset, not a 'sunk' capex cost – 'if it's surplus to requirements, sell it'
- SL7** Removes or reduces building related compliance issues and associated costs to BWOFF
- SL7** Can be used inside or outside a building – regulatory conditions apply\*
- SL7** 237% lighter per m2 to equivalent 190mm tilt slab concrete panel equivalent
- SL7** Between 30%-40% cheaper than equivalent sized concrete structure – based on customer comments.
- SL7** Two (2) doors - Full side opening providing unencumbered access
- SL7** Vault is approved for local transportation and international shipping

#### *Testing Approvals:*

This product has been independently tested and approved to AS1530.4 under the building code and the requirements of 240/240/240 FRR. It also meets the requirements of UL1709 and its requisite 4 hour jet pool fire test.

<b>Technical Data &amp; Properties</b>	
Colour – outside	Black
Colour – inside	Light grey
Paint	Two pack epoxy
Internal bund capacity	5,000 litres
Floor material	Fibreglass/Plastic grated
External length	6058mm
External width	2438mm
External height	2896mm
Internal length	5802mm
Internal width	2140mm
Internal height – floor to upper door access	2323mm
Internal height – floor to ceiling	2374mm
Doors	2 x 3 metre doors hinged from each end
Approximate weight	11,000kg
Shipping/Transportation	ISO frame approved for international distribution
Insulation factor	120 degrees Celsius

***“Relocatable, Zero Separation & 4hr Fire Protection”***



## DG6MHC VAULT

### Product/Technical Data Sheet

#### Test Summary Report

SL7 products have been independently tested to, and exceed the requirements for 240/240/240 FRR against AS1530.4 as specified. Clicking the following .pdf for your copy of the test summary report;



SL7 Test Report  
Summary.pdf

#### Compliance:

SL7 products are issued with a compliance plate affixed to the front/side giving details required by a registered test certifier to show that it meets all of the requirements of the regulations.

SL7 issues a PS1 & PS4 certifying compliance to AS1530.4.

#### Installation Requirements:

The vault needs to be placed on a concrete pad that is level ideally or at a minimum on a prepared level ground surface of compacted aggregates with the final preparation being an AP20 aggregate or similar.

#### Safety Instructions:

The doors should be secured at all times whether closed or opened to avoid any movement which could result in unintended harm.

#### Packing/Storage Examples:

These are examples of the stowage capacities of the DG6MHC Vault, based on general accepted 200 litre drum and IBC dimensions;

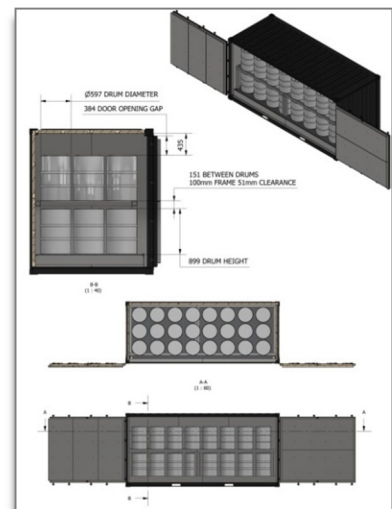
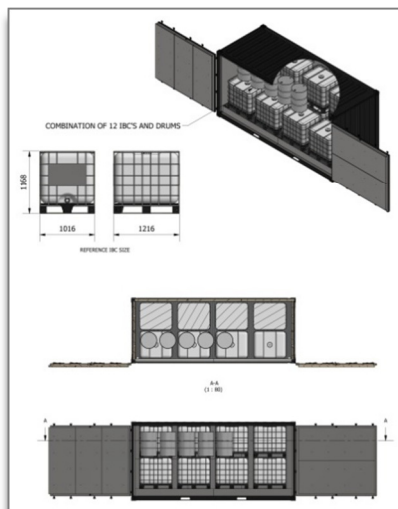
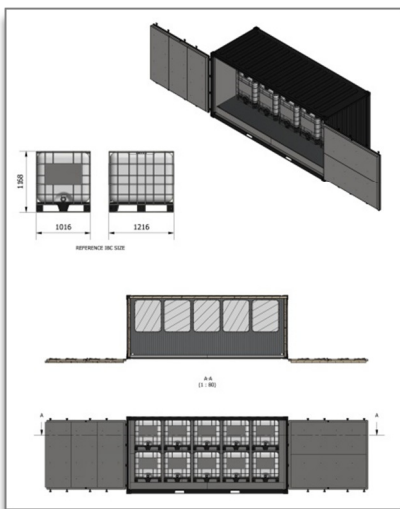

SL7-Vaults www.sl7.co.nz	
Serial Number	
Manufactured by	SL7 Innovations Limited
Fabrication No.	
Model	
FRR Rating	240/240/240
FRR Standard	UL1709
Secondary Containment Capacity	
Compliance Code	AS 1530.4
Registration Location - GPS Coords.	
Customer Ownership Name	

**"Relocatable, Zero Separation & 4hr Fire Protection"**



## DG6MHC VAULT

### Product/Technical Data Sheet

#### *Dimensional Specifications:*

These dimensional specifications can vary slightly from actual based on manufacturing tolerance;

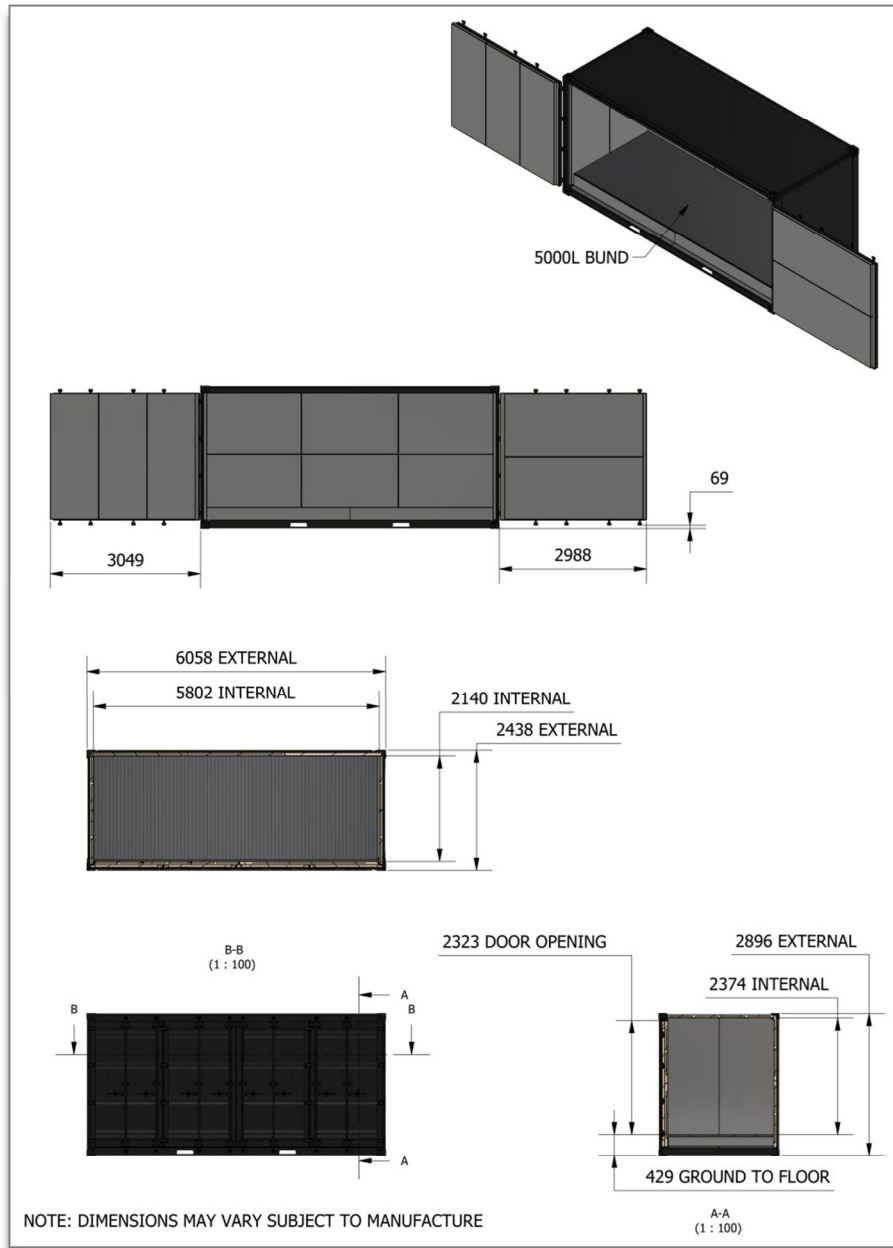

#### *SL7 – New Zealand & Australia Enquiries:*

SL7 Innovations Limited  
66-68 Carmen Road, Hornby, Christchurch, New Zealand  
Mobiles: +64 27 460 9254 or +64 27 460 9258  
Emails: [paul@SL7.co.nz](mailto:paul@SL7.co.nz) or [lionel@SL7.co.nz](mailto:lionel@SL7.co.nz)  
Website: [www.SL7.co.nz](http://www.SL7.co.nz)

***“Relocatable, Zero Separation & 4hr Fire Protection”***